

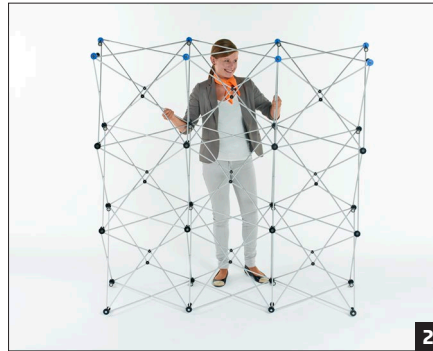

# PVC exhibition wall



Remove the print rails, worm fence system and magnetic strips from the pop-up case.



Unfold the worm fence system by pulling apart the upper corners on the outside. Make sure that the blue fasteners are on the top.



To put the three magnetic rail parts together, first gently pull them apart and then push them together.



Attach the magnetic rails vertically to the curved front side of the system. Starting with the top, press the rails onto the upper magnet points.



Gently push the entire magnetic rails downwards until they lock in place.



Starting on the side, begin to attach the print to the system.

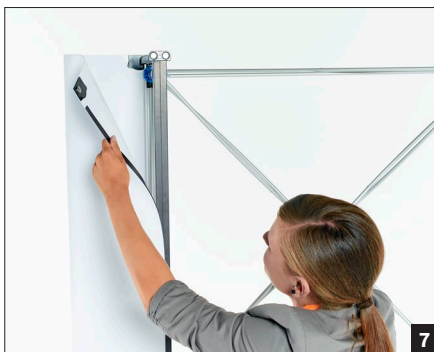

Fix the print rails to the system using the magnets on the top of the prints.



Lower the rails and fix them to the side magnets. Align the print rails with one another to the magnetic rails to achieve an optimal print image.

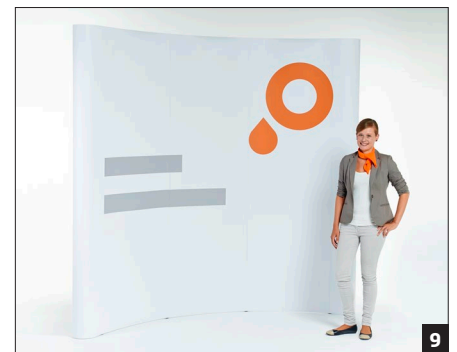

Here is your PVC exhibition wall in full size.